

Magnetic Pickup

P/N 66.60.001-5818-L

Dimensions

- Thread 5/8-18 UNF
- Length 63.5 mm (2.5"), 127 mm (5"), 152.4 mm (6")
(more dimensions see *Overview Drawing*)

Connections

- Pole connector 2-pole, male, thread 5/8-24 UNEF
- Pin B turns positive with respect to Pin A at the transition from non-ferromagnetic to ferromagnetic material.

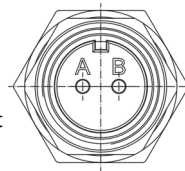

Triggering

- Possible triggers Through holes, metal inserts, blind holes, slots, screws, pins, teeth

Mechanical Data

- Air gap 0.5 mm to 1 mm (0.02" to 0.04")
- Change of distance 1 revolution \pm 1.4 mm (0.05")
- Tightening torque 15 Nm
- Protection class IP68
- Enclosure material and nut Stainless steel (300 series)
- Case hexagon Wrench opening 17
- Hexagon nut Wrench opening 19

Climatic Environmental Conditions

- Permissible temperature range $-40\text{ }^{\circ}\text{C}$ to $+110\text{ }^{\circ}\text{C}$ ($-40\text{ }^{\circ}\text{F}$ to $+230\text{ }^{\circ}\text{F}$)

Electrical Data

- Resistance $1,200\ \Omega \pm 20\%$
- Inductivity $450\ \text{mH} \pm 20\%$ at 1 kHz and $+25\text{ }^{\circ}\text{C}$ ($+77\text{ }^{\circ}\text{F}$)
- Output voltage Gear wheel: 60 teeth
Air gap: 0.5 mm (0.02")
Load: 10 k Ω , 33 k Ω , 100 k Ω
See reference gear wheel and diagram
Nominal Voltage / Speed

Overview Drawing

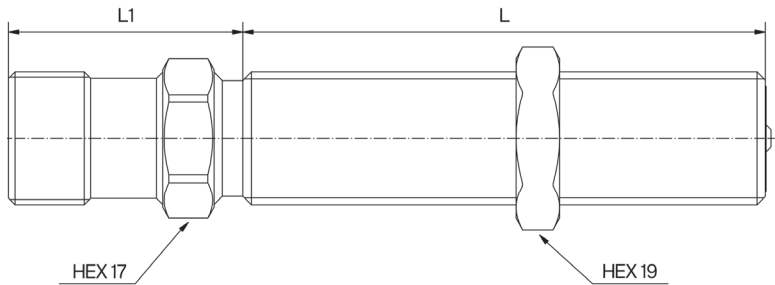

| Feature | P/N | Value |
|---------|------|-----------------|
| L | -064 | 63.5 mm (2.5") |
| | -127 | 127 mm (5.0") |
| | -152 | 152.4 mm (6.0") |
| L1 | | 28.5 mm (1.12") |

Reference Gear Wheel

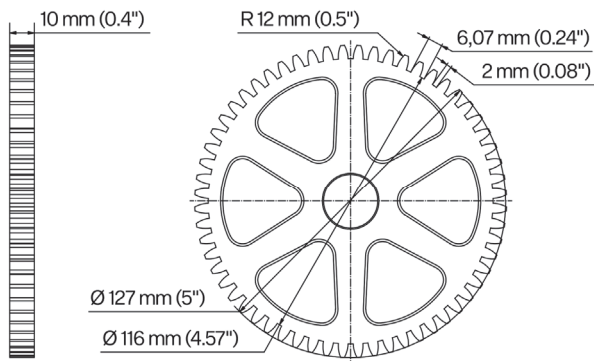

Nominal Voltage / Speed

