

## I Throttle Body with Integrated Stepper Motor

P/N 30.43.200-D, P/N 30.43.200-D-HT, P/N 30.43.205-D, P/N 30.43.205-D-HT

### Variations

- Standard diameters D of the throttle (*see drawing*) 100 mm (3.94"), 105 mm (4.13"), 110 mm (4.33"), 115 mm (4.53"), 120 mm (4.72"), 125 mm (4.92")
- Possible diameters of the throttle 98 mm (3.86") to 125 mm (4.92")

### Dimensions

- Length/width of mounting flange 179 mm (7.05")
- Hole spacing on the mounting flange 126 mm (4.96")
- Height of mounting flange 110 mm (4.33")
- Length including stepper motor 351.85 mm (13.85") (*standard version*)  
376.85 mm (14.84") (*HT version*)
- Width of stepper motor 85.9 mm (3.38")

### Connections

- Stepper motor 10-pole military connector

### Weight

- P/N 30.43.200-100, P/N 30.43.205-100 8.4 kg (15.52 lbs)
- P/N 30.43.200-105, P/N 30.43.205-105 8.1 kg (17.86 lbs)
- P/N 30.43.200-110, P/N 30.43.205-110 7.8 kg (17.20 lbs)
- P/N 30.43.200-115, P/N 30.43.205-115 7.5 kg (16.53 lbs)
- P/N 30.43.200-120, P/N 30.43.205-120 7.2 kg (15.87 lbs)
- P/N 30.43.200-125, P/N 30.43.205-125 6.9 kg (15.21 lbs)
- P/N 30.43.200-100-HT, P/N 30.43.205-100-HT 8.5 kg (18.74 lbs)
- P/N 30.43.200-105-HT, P/N 30.43.205-105-HT 8.2 kg (18.10 lbs)
- P/N 30.43.200-110-HT, P/N 30.43.205-110-HT 7.9 kg (17.42 lbs)
- P/N 30.43.200-115-HT, P/N 30.43.205-115-HT 7.6 kg (16.76 lbs)
- P/N 30.43.200-120-HT, P/N 30.43.205-120-HT 7.3 kg (16.09 lbs)
- P/N 30.43.200-125-HT, P/N 30.43.205-125-HT 7.0 kg (15.43 lbs)

### Mechanical Data

- Maximum rotation angle of the throttle 80°
- Chemical resistance Water, oil, gaseous fuels
- Absolute pressure 4.5 bar (65 psi)
- Maximum temperature of media flowing through +125 °C (+257 °F) (*standard version*)  
+200 °C (+392 °F) (*HT version*)

### Climatic Environmental Conditions

- Permissible temperature range -20 °C to +85 °C (-4 °F to +185 °F)
- Maximum relative humidity 95%

### Characteristics of Stepper Motor

- Resolution 0.1125°(in 1/16 microstep operation mode)
- Speed (when opening from 10% to 90%) 40 ms (*VariStep3*)
- Holding torque 5.4 Nm (3.98 lb-ft) (*VariStep3*)

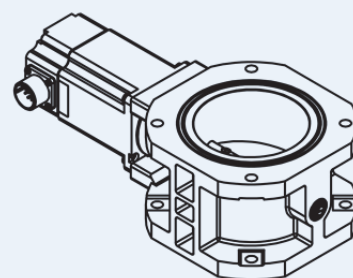

## Overview Drawings

P/N 30.43.205-D and P/N 30.43.205-D-HT also correspond to the following drawings, but without the seal (O-ring, 148.82 mm x 3.53 mm [5.86" x 0.14"]) and the groove required for it.

### P/N 30.43.200-D

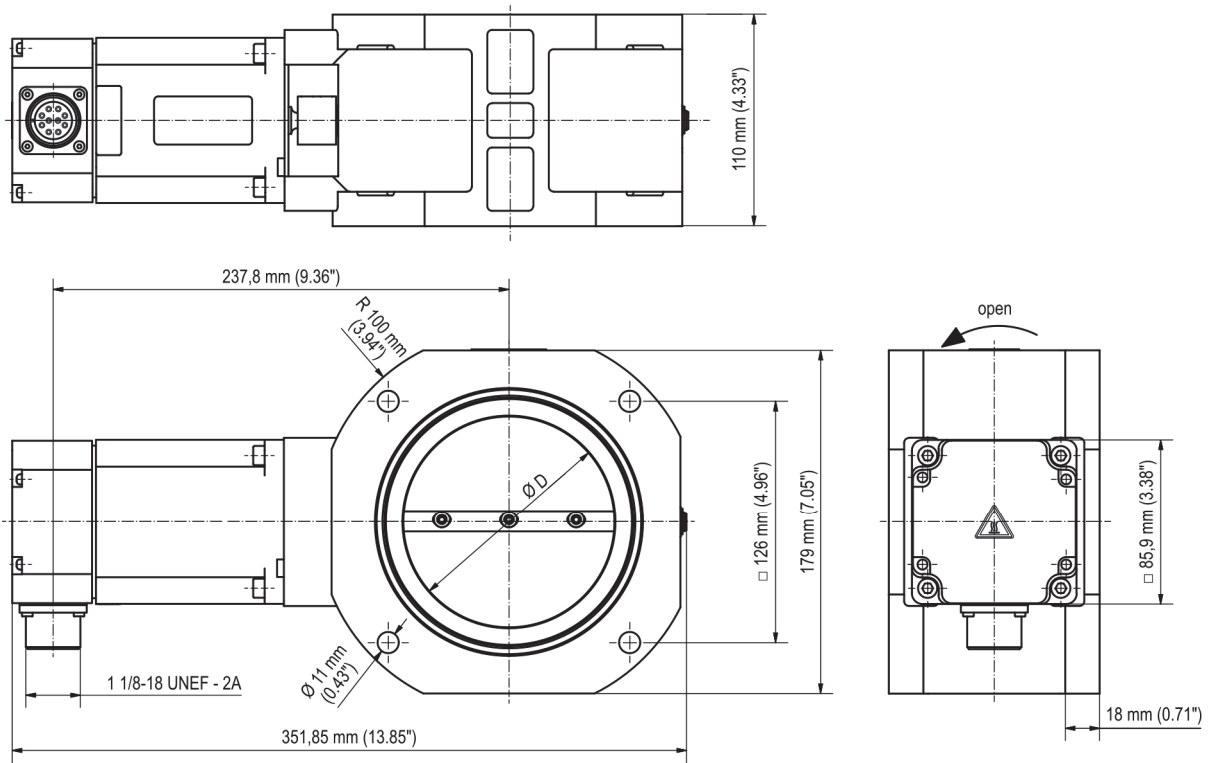

### P/N 30.43.200-D-HT

