

I Throttle Body with Integrated Stepper Motor

P/N 30.43.050-D, P/N 30.43.050-D-HT, P/N 30.43.055-D, P/N 30.43.055-D-HT

Variations

- Standard diameters D of the throttle (*see drawing*) 42 mm (1.65")
- Possible diameters of the throttle 41 mm (1.61") to 42 mm (1.65")

Dimensions

- Length/width of mounting flange 86.7 mm (3.41")
- Hole spacing on the mounting flange 57 mm (2.24")
- Height of mounting flange 40 mm (1.57")
- Length including stepper motor 232.9 mm (9.17") (*standard version*)
247.9 mm (9.76") (*HT version*)
- Width of stepper motor 56.4 mm (2.22")

Connections

- Stepper motor 10-pole military connector

Weight

- P/N 30.43.050-42, P/N 30.43.055-42 2.1 kg (4.63 lbs)
- P/N 30.43.050-42-HT, P/N 30.43.055-42-HT 2.2 kg (4.85 lbs)

Mechanical Data

- Maximum rotation angle of the throttle 80°
- Chemical resistance Water, oil, gaseous fuels
- Absolute pressure 4.5 bar (65 psi)
- Maximum temperature of media flowing through +125 °C (+257 °F) (*standard version*)
+200 °C (+392 °F) (*HT version*)

Climatic Environmental Conditions

- Permissible temperature range -20 °C to +85 °C (-4 °F to +185 °F)
- Maximum relative humidity 95%

Characteristics of Stepper Motor

- Resolution 0,05625°
(in 1/16 microstep operation mode)
- Speed (when opening from 10% to 90%) 40 ms (*VariStep3*)
- Holding torque 1.7 Nm (1.25 lb-ft) (*VariStep3*)

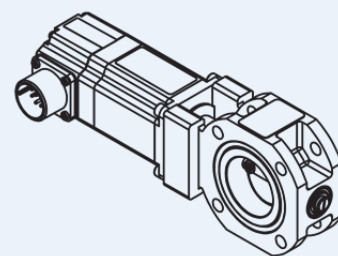

Overview Drawings

P/N 30.43.055-D and P/N 30.43.055-D-HT also correspond to the following drawings, but without the seal (O-ring, 56.75 mm x 3.53 mm [2.23" x 0.14"]) and the groove required for it.

P/N 30.43.050-D

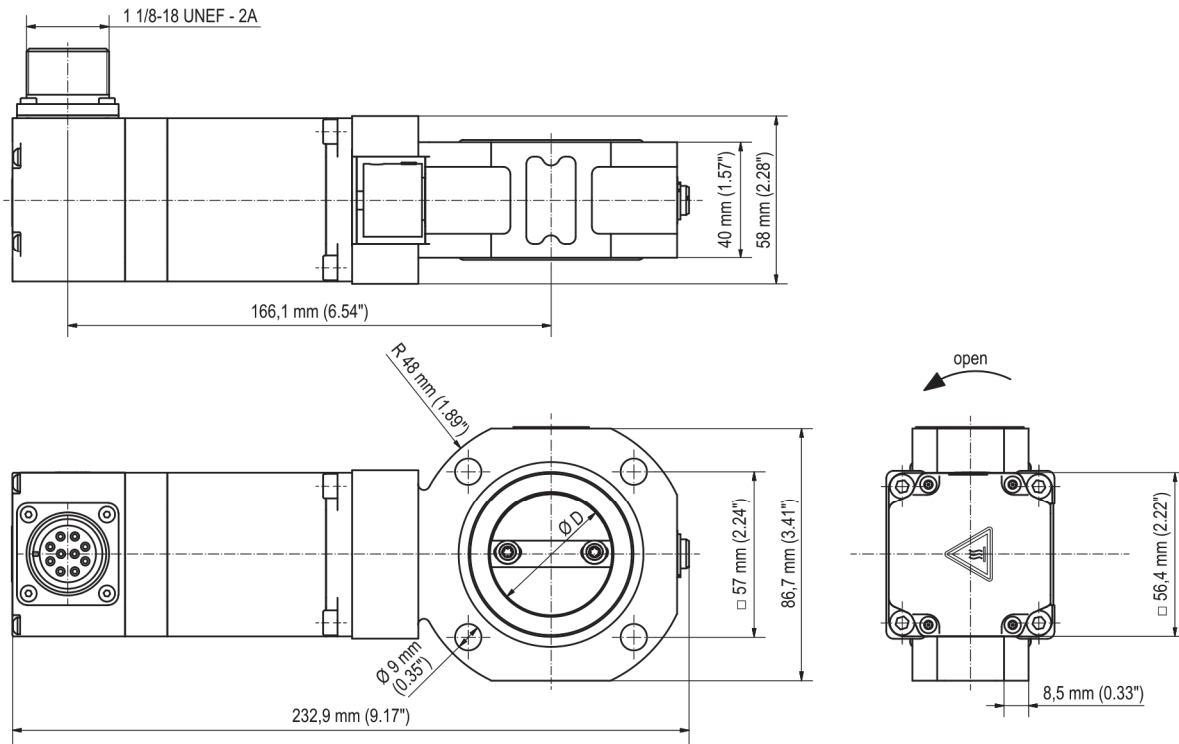

P/N 30.43.050-D-HT

