

Ignition Coil

P/N 06.50.154

Dimensions

- length 292.3 mm (11.5")
- diameter connection 15 mm (0.6")
(more dimensions see drawing)

Connections

- primary side 2 pin DEUTSCH® connector
- secondary side Female

Mechanical Data

- weight Approx. 1.8 kg (4.0 lb)
- torque for installation According to CATERPILLAR® installation instructions

Climatic Environmental Conditions

- permissible temperature range -20 °C to +120 °C
(-4 °F to +248 °F)
- maximum relative humidity 95 %

Electrical Data

- maximum secondary voltage 40 kV ± 2.5 kV
- resistance secondary side 27 kΩ ± 1.2 kΩ

Compatibility

- equivalent to following ignition coils 418-4862, 259-2078
- compatible ignition controllers EIS Ignition
- compatible engines CATERPILLAR® G3500 Series
(CSA applications)

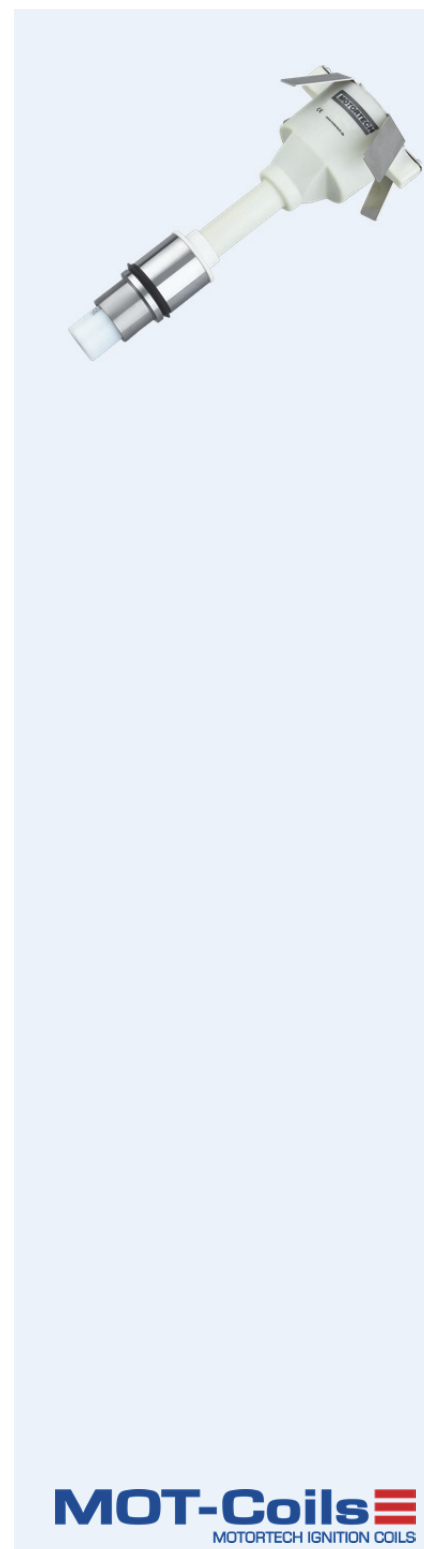

Overview Drawing

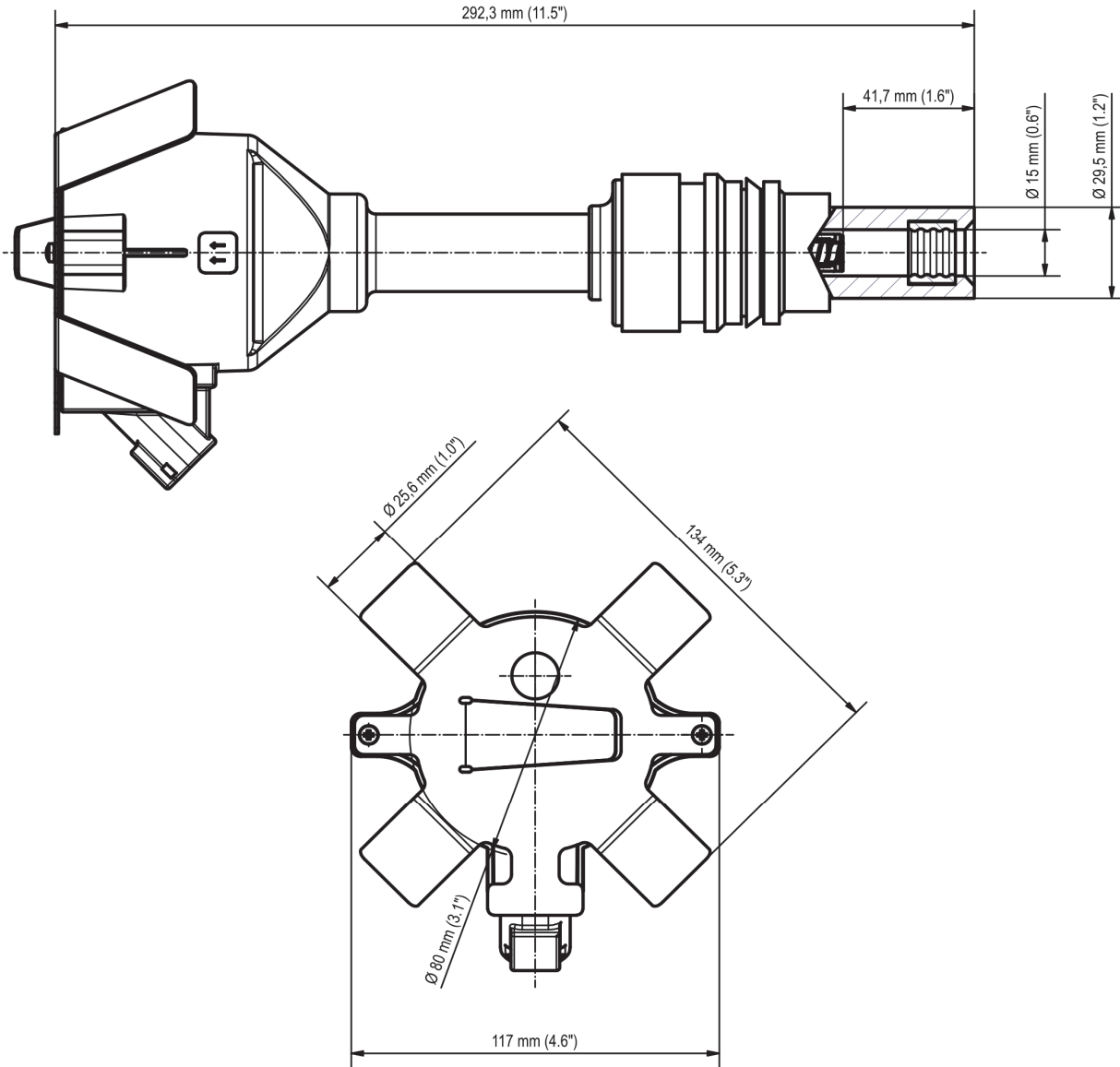

Coil Circuit Diagram

